

VOFX-LT-M32C-...-3AA1/-1A1-EX2-N/-1-EX4-M Pilot valve

FESTO

Festo SE & Co. KG

Ruiter Straße 82
73734 Esslingen
Germany
+49 711 347-0
www.festo.com

Installation- and service instruction

8195271
2023-05
[8195273]

VOFX-LT-M32C-MY-G18-SG18-3AA1/-1A1-EX2-N/-1-EX4-M English

To assure the function and for your own safety please read the following operating instructions carefully, before installing the product.

1 In General

Please notice that not following these instructions or any kind of inappropriate engagement lead to the end of any kind of warranty and liability from our side. Application and operation of the device must ensue in accordance to general terms of technology.

Please undertake any means to avoid unintended actuation and inappropriate use.

Always take into consideration that pressurised fittings, tubes and systems are not to be opened.

Observe all national and international regulation of relevance.



Warnings

The products may only be installed and maintained by properly trained and authorized work-force and under consideration of the relevant regulations. Always take into consideration that pressurised fittings, tubes and systems are not to be opened.

Do not bend the product.

Avoid injury. The valve, especially the coil of electrically actuated valves, might become very hot.

Do not step onto the product.

2 Installation

When taking the product out of the packaging take care that no dirt or other particles are coming into the product.

Only use appropriate fittings that do not cause or lead to any dirt in the system. Only use clean fittings and tubing.

Observe the manual of the actuator.

Install the product in a way that regular cleaning is possible.

Do not over-bend hoses or cables. Close unused ports.

Make sure that the exhaust ports are kept open, protect the exhaust ports against condensate, dirt, insects etc.

Avoid water entering the exhaust port.

The mounting torque of the banjo-screw should be 7 Nm -0/+1 Nm.

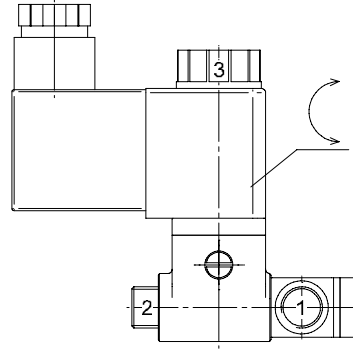

Port configuration:

- Port 1: Pressure supply port
- Port 2: Working port (connect with actuator)
- Port 3: Exhaust port

3 Operation

Only use cleaned and lubricated or cleaned and unlubricated compressed air quality level 7-4-4 for particles – water – oil following ISO 8573-1:2010.

The temperature of the compressed air and the environment must be between –10 °C and +50 °C. The operating pressure range of the valve is -0,9 to 8 bar.

Using the valve below 0°C make sure to use dried air.

Further operation relevant information should be taken from the technical datasheet.

Over-pressurising might lead to function failures.

Over-voltage might lead to burn out of the coil.

4 Service

The product is usually maintenance-free.

Check the function of the products regularly, minimum every 6 month or after 5 million switches.

5 Malfunctioning

Check the electric as well as pneumatic connections, operating pressure and voltage.

If the problems are not solved by these, make sure before dismantling, that there is no pressure applied to the ports and no electricity applied to the coil. Dismantle the product.

Address authorised and educated personnel.

6 Technical characteristics of the coil

VOFX-LT-M32C-...	-3AA1	-1A1-EX2-N	-1-EX4-M	
Coil characteristics	[V]	230 AC	24 DC	24 DC
	[W]	–	2,1	2,6
Permissible voltage fluctuations	[%]	± 10	± 10	± 10
Electrical connection		EN 175301-803, type A	EN 175301-803, type A	Encapsulated Cable connector